



2600 AIRLINE DRIVE

METAIRIE, LA 70001

New Retail Development
in Old Metairie!

FOR LEASE



SITE INFORMATION

Rare new development opportunity on heavily trafficked Airline Drive near signalized intersection at Labarre Rd, across from the Labarre Retail Shopping Center and Rouse's grocery-anchored shopping center. High traffic counts at 38,356 average daily traffic. The property is located one block off Causeway Blvd, with excellent visibility. Landlord will deliver a cold dark shell.

LOCATION:	2600 Airline Drive Metairie, LA 70001
BUILDING SIZE:	7,450 square feet
PARKING:	43 spaces
RENT:	\$36 PSF NNN (estimated at \$7.50 PSF)
TRAFFIC COUNT:	38,356 Average Daily Traffic (Airline Dr) 53,709 ADT (Causeway Blvd)
ZONING:	M1 zoning

DEMOGRAPHICS



DRIVE TIME	TOTAL POPULATION	TOTAL # HOUSEHOLDS	MEDIAN HH INCOME	AVERAGE HH INCOME
5 MINUTES	20,798	9,175	\$53,755	\$86,335
10 MINUTES	161,941	71,644	\$45,675	\$71,772
15 MINUTES	393,960	172,969	\$47,261	\$74,156

ARCHITECT'S RENDERING



MSA: NEW ORLEANS - METAIRIE

NEW RETAIL DEVELOPMENT

CONTACT: kearly@srsa-realestate.com



2600 AIRLINE DRIVE

METAIRIE, LA 70001

New Retail Development
in Old Metairie!

FOR LEASE

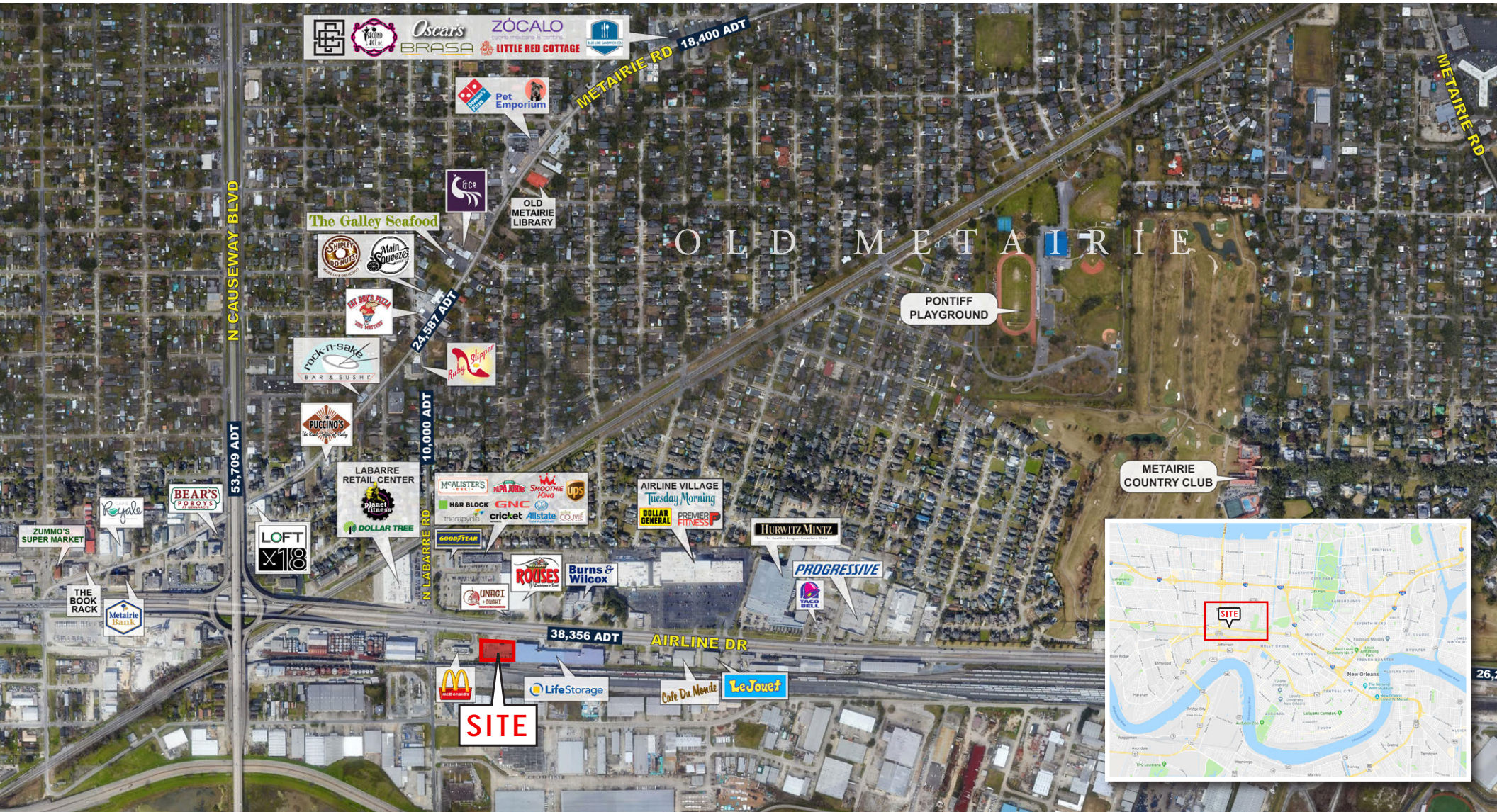

MSA: NEW ORLEANS - METAIRIE

NEW RETAIL DEVELOPMENT

CONTACT: kearly@srsa-realestate.com



2600 AIRLINE DRIVE

METAIRIE, LA 70001

New Retail Development
in Old Metairie!

FOR LEASE

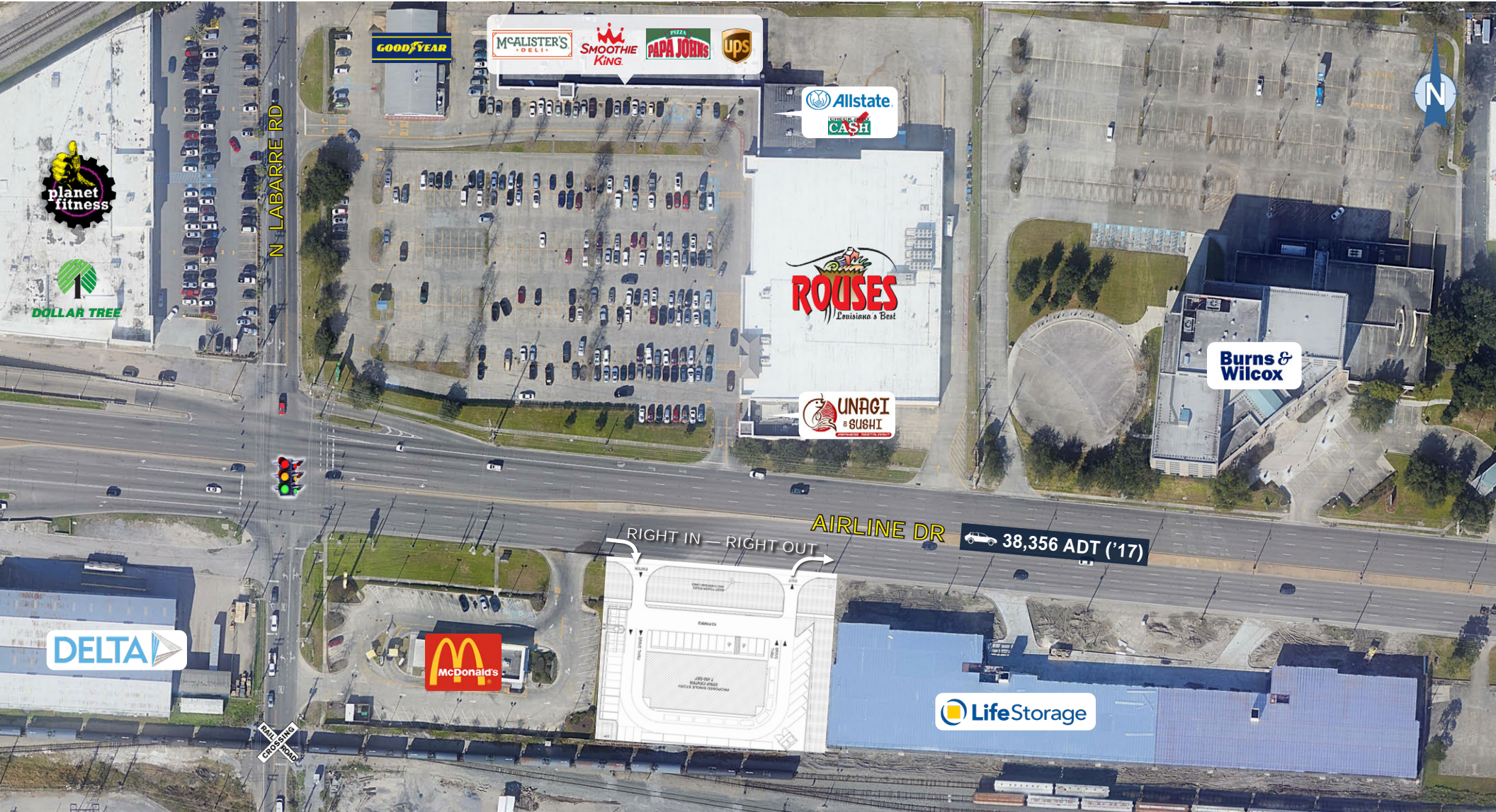

MSA: NEW ORLEANS - METAIRIE

NEW RETAIL DEVELOPMENT

CONTACT: kearly@srsa-realestate.com

504-831-2363

SRSACommercial.com



2555 Severn Avenue
Suite 200
Metairie, LA 70002

Kirsten Early, CCIM
504-620-0352
kearly@srsa-realestate.com

Stephanie Hilferty
504-620-0354
shilferty@srsa-realestate.com

PARTNER **XTEAM**
RETAIL ADVISORS



SRSA COMMERCIAL
REAL ESTATE



2600 AIRLINE DRIVE

METAIRIE, LA 70001

New Retail Development in Old Metairie!

FOR LEASE

PROPOSED SITE PLAN

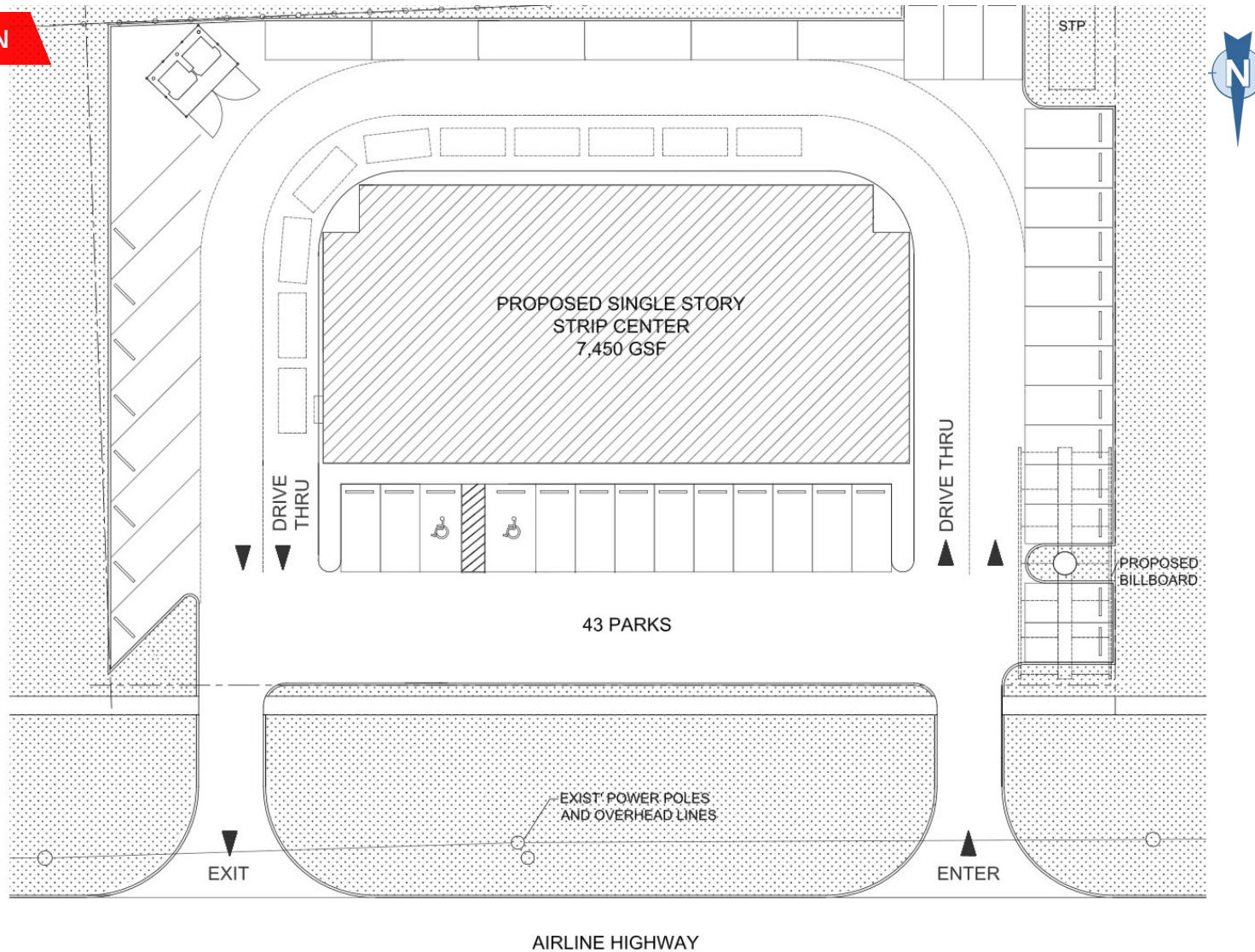

MSA: NEW ORLEANS - METAIRIE

NEW RETAIL DEVELOPMENT

CONTACT: kearly@srsa-realestate.com



2600 AIRLINE DRIVE

METAIRIE, LA 70001

New Retail Development
in Old Metairie!

FOR LEASE



MSA: NEW ORLEANS - METAIRIE

NEW RETAIL DEVELOPMENT

CONTACT: kearly@srsa-realestate.com

504-831-2363
SRSAcommercial.com
f in

2555 Severn Avenue
Suite 200
Metairie, LA 70002

Kirsten Early, CCIM
504-620-0352
kearly@srsa-realestate.com

Stephanie Hilferty
504-620-0354
shilferty@srsa-realestate.com

PARTNER **XTEAM**
RETAIL ADVISORS

SRSA
SRSA COMMERCIAL
REAL ESTATE

Customer Information Form

What Customers Need to Know When Working With Real Estate Brokers or Licensees

This document describes the various types of agency relationships that can exist in real estate transactions.

AGENCY means a relationship in which a real estate broker or licensee represents a client by the client’s consent, whether expressed or implied, in an immovable property transaction. An agency relationship is formed when a real estate licensee works for you in your best interest and represents you. Agency relationships can be formed with buyers/sellers and lessors/lessees.

DESIGNATED AGENCY means the agency relationship that shall be presumed to exist when a licensee engaged in any real estate transaction, except as otherwise provided in LA R.S. 9:3891, is working with a client, unless there is a written agreement providing for a different relationship.

- The law presumes that the real estate licensee you work with is your designated agent, unless you have a written agreement otherwise.
- No other licensees in the office work for you, unless disclosed and approved by you.
- You should confine your discussions of buying/selling to your designated agent or agents only.

DUAL AGENCY means an agency relationship in which a licensee is working with both buyer and seller or both landlord and tenant in the same transaction. Such a relationship shall not constitute dual agency if the licensee is the seller of property that he/she owns or if the property is owned by a real estate business of which the licensee is the sole proprietor and agent. A dual agency relationship shall not be construed to exist in a circumstance in which the licensee is working with both landlord and tenant as to a lease that does not exceed a term of three years and the licensee is the landlord. Dual agency is allowed only when informed consent is presumed to have been given by any client who signed the dual agency disclosure form prescribed by the Louisiana Real Estate Commission. Specific duties owed to both buyer/seller and lessor/lessee are:

- To treat all clients honestly.
- To provide factual information about the property.
- To disclose all latent material defects in the property that are known to them.
- To help the buyer compare financing options.
- To provide information about comparable properties that have sold, so that both clients may make educated buying/selling decisions.
- To disclose financial qualifications to the buyer/lessee to the seller/lessor.
- To explain real estate terms.
- To help buyers/lessees arrange for property inspections
- To explain closing costs and procedures.

CONFIDENTIAL INFORMATION means information obtained by a licensee from a client during the term of a brokerage agreement that was made confidential by the written request or written instruction of the client or is information the disclosure of which could materially harm the position of the client, unless at any time any of the following occur:

- The client permits the disclosure by word or conduct.
- The disclosure is required by law or would reveal serious defect.
- The information became public from a source other than the licensee.

By signing below you acknowledge that you have read and understand this form and that you are authorized to sign this form in the capacity in which you have signed.

Buyer/Lessee:

Seller/Lessor:

By: _____
Title: _____
Date: _____
Licensee: _____
Date: _____

By: _____
Title: _____
Date: _____
Licensee: _____
Date: _____

